

# Styrofoam\* Roofmate\* with Lotus Exposed Membrane Application Details

Schematics Only – Not to Scale

Proposed By WMK Coating Sdn Bhd

5<sup>th</sup> July 2012

**Overlapping Joints** to be constructed as per Lotus Series Slated Membrane's manufacturer's specifications of Adhesive and/or Mechanical fixing

**4mm thk Lotus Series Slated Membrane** to be laid in accordance with manufacturer's guidelines.

## Optional Extra for Mechanical Impact Protection

Autoclaved Fibre Cement Boards are readily available different thickness depending upon the mechanical resistant required.

- 1220 x 2440 x 4.5mm (thk)
- 1220 x 2440 x 6.0mm (thk)
- 1220 x 2440 x 9.0mm (thk)

Autoclaved Boards are highly recommended for their stability against weather such as: Primaflex (Hume), Supaflex (USG), Promatech 50 (Promat) or equivalent. Boards are recommended if a torch on system is applied to protect the Styrofoam\* Roofmate\*

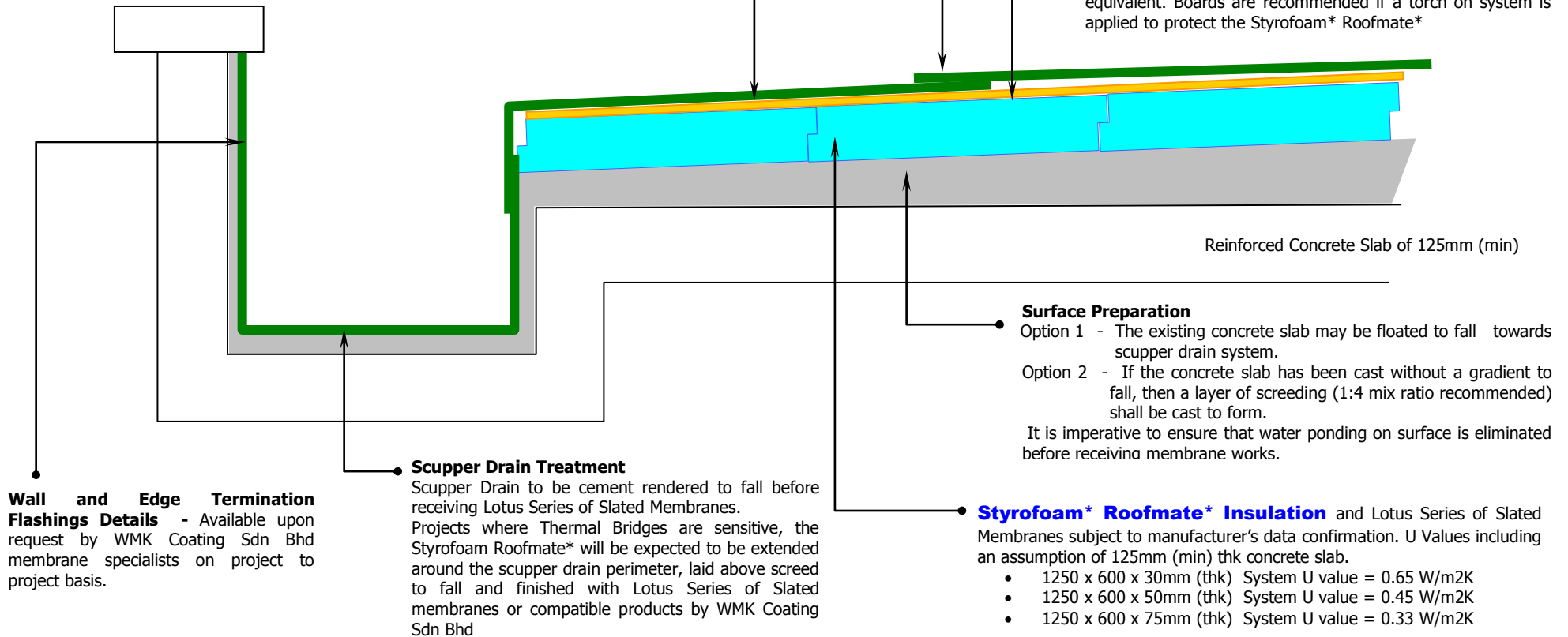

Reinforced Concrete Slab of 125mm (min)

## Surface Preparation

- Option 1 - The existing concrete slab may be floated to fall towards scupper drain system.
  - Option 2 - If the concrete slab has been cast without a gradient to fall, then a layer of screeding (1:4 mix ratio recommended) shall be cast to form.
- It is imperative to ensure that water ponding on surface is eliminated before receiving membrane works.

**Styrofoam\* Roofmate\* Insulation** and Lotus Series of Slated Membranes subject to manufacturer's data confirmation. U Values including an assumption of 125mm (min) thk concrete slab.

- 1250 x 600 x 30mm (thk) System U value = 0.65 W/m<sup>2</sup>K
- 1250 x 600 x 50mm (thk) System U value = 0.45 W/m<sup>2</sup>K
- 1250 x 600 x 75mm (thk) System U value = 0.33 W/m<sup>2</sup>K

**Wall and Edge Termination Flashings Details** - Available upon request by WMK Coating Sdn Bhd membrane specialists on project to project basis.

## Scupper Drain Treatment

Scupper Drain to be cement rendered to fall before receiving Lotus Series of Slated Membranes. Projects where Thermal Bridges are sensitive, the Styrofoam Roofmate\* will be expected to be extended around the scupper drain perimeter, laid above screed to fall and finished with Lotus Series of Slated membranes or compatible products by WMK Coating Sdn Bhd

NB

The above is an indicative schematic issued as a preliminary guide only for designers and installers. Proposed changes were adopted based on data received from specialist contractors over a period of time. The actual construction details are to be approved by the project consultants before implementation. Each project has differing construction details and no two site situations are the same where Styrofoam\* products may be applied in more ways than one and therefore The Dow Chemical Group and it's distributors are not liable for the final design nor execution on site.